

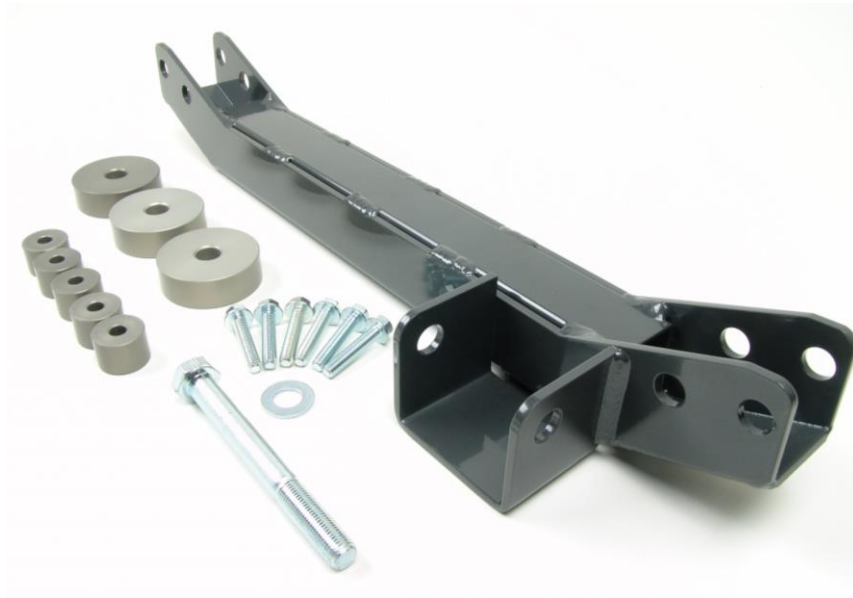

700 Pine Ridge Road Golden CO 80403 Tel (303) 278 8287 1(888) 4X4 SLEE Fax (303) 278 7182

Slee Off-Road - Diff Drop Kit 1998-07 Land Cruiser / LX470 (SOK006) – Installation Instructions



Qty	Part Description	Qty	Part Description
1	Diff Drop Bracket – Powder Coated	1	14mm x 130mm Bolt – Zinc Plated
3	63mm x 20mm - Anodized Round Spacer	6	8mm x 40mm – Flange Head Bolt – Zinc Plated
5	28mm x 20mm – Anodized Round Spacer	1	14mm Flat Washer – Zinc

Thank you for your purchase from Slee Off-Road! If you should you have any questions or concerns, please do not hesitate to contact us immediately at 1 888 4X4 SLEE or at sales@sleeoffroad.com.

Slee Off-Road strives to provide comprehensive installation instructions. However, in some circumstances minor inconsistencies may be encountered with instructions and or provided parts. If you encounter such an inconsistency, please notify us, as your input is important. Slee Off-Road guarantees all parts free from defects for one year from the original purchase date.

Slee Off-Road and Slee & Co under no circumstances will be held liable for any damages or injuries to the users of this product(s) and or their equipment as a result of the use of this information or parts obtained from Slee Off-Road.



1. Secure vehicle with wheel chocks and jack the front of the vehicle up safely. Place the front frame rails on jack stands. It is not necessary to remove the front wheels but the frame should be supported by jack stands.
2. Remove front splash pan and fiberglass belly pan.



3. Support the rear of the front of the differential using a floor jack or other support.

Loosen the existing cross member by removing the two bolts on either side as shown. Loosen the nuts and not the bolts.

Side bolts of the existing cross member **(Step 3A)**



Side bolts of the existing cross member **(Step 3B)**



Side bolts of the existing cross member **(Step 3C)**



Remove bolt as indicated **(Step 4)**

4. Remove the rear bolt that attaches the differential control arm to the cross member. Make sure the differential is supported and remove the cross member.

- Mounting bolt - torque – 137 ft. lbs.



Remove bolt as indicated **(Step 5)**

5. While the differential is supported, remove the front mounting bolt and rubber spacer. This bolt doesn't have a nut on top (captive nut).



Rear Mounting Bolt **(Step 6)**

6. Remove the rear mounting bolt. This bolt has a nut on the top side. Do not discard this bolt and washer. It will be re-used as the front mounting bolt.



New Slee Cross Member bracket installed (**Step 7**)

7. Install the new cross member using the existing hardware that was removed in Steps 3 & 4. Leave bolts finger tight.

- Side Mounting bolts
Torque – 50 ft. lbs.
- Rear mounting bolt
Torque – 137 ft. lbs.



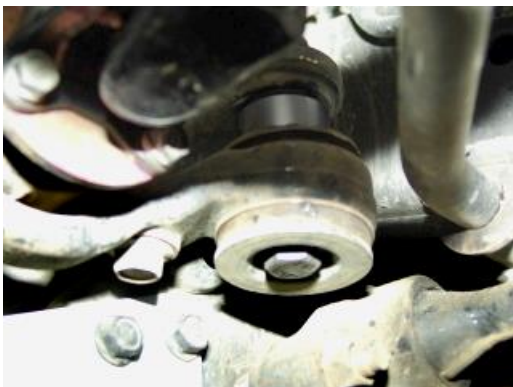

8. Using the old 14mm bolt (removed in step 6) and the 63mm x 20mm Round Spacer, re-attach the front differential mount. Leave finger tight.

- Mounting bolt - Torque
– 137 ft. lbs.



9. Using the new supplied 14mm x 130mm bolt and washer, large washer and nut (removed in step 6) install the rear differential mount. Use the 63mm x 20mm round spacer between the frame mount and the differential. Leave finger tight.

- Mounting bolt - Torque
– 137 ft. lbs.

	<p>10. Torque all the bolts to spec as listed above Steps.</p>
 <p>63mm <i>round</i> spacer (square spacer used on old version) (Step 11)</p>	<p>11. Re-install the plastic belly pan and front splash pan. Use the 63mm round spacer on the center mounting hole. Use the supplied 8mm x 40mm flange bolt in this location (see photo).</p> <p>Use the five 28mm x 20mm round spacers on the front and side mounting holes of the metal skid plate. For these five locations use the supplied 8mm x 40mm flange bolts.</p>
	<p>12. Location of the three front splash pan spacers with factory pan installed.</p>

Thank you for your purchase from Slee Off-Road! Visit us at sleeoffroad.com or email us at sales@sleeoffroad.com. Follow us on Facebook and Instagram!

